



SANDING *KIT*



AUTOMATE ONE OF THE TOUGHEST, DIRTIEST JOBS

- Save hours of programming
- Increase quality and productivity
- Reduce worker injuries
- The only complete sanding solution for Universal Robots

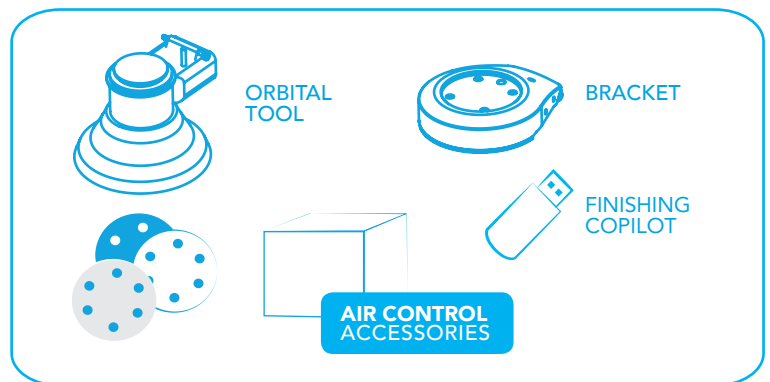

**START
PRODUCTION
FASTER**

SUPPORTED MATERIALS



WOOD

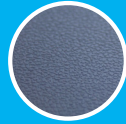

PLASTIC



METAL



FIBERGLASS



SOLID SURFACE

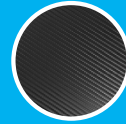

CARBON FIBER

GENERATE A FINISHING PATH IN MINUTES

Program complex finishing trajectories by teaching less than 10 waypoints, even on complex, spherical surfaces. Apply constant force at each cycle.

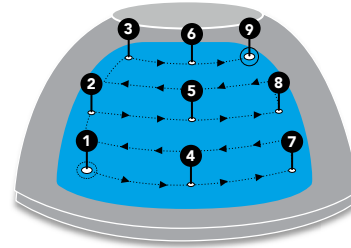

PRO TIPS

Robotiq is a pioneer in force control for collaborative robots. Our sanding [e-learning platform](#) includes our best lessons learned in the past 10 years. Use it to save hours of programming: elearning.robotiq.com.

VALIDATE PART LOCATION

Use reference points on the part to validate its location with a precision of 0.2 mm. If there's a slight change, the robot program will automatically adapt all related parameters.



SPECIFICATIONS

Random orbital sander	
Maximum air supply	6.2 bar (90 PSI)
Air flow (full speed)	450 L/min (16 SCFM)
Pad diameter	5"
Media	Hook and loop; 5 holes
Orbit diameter	3/16"
Maximum speed	12,000 RPM
Air supply inlet	1/4" NPT thread
Dust exhaust	Central vacuum ready; 1" (25 mm) diameter.

Robotiq bracket	
Weight	0.42 kg
Added height	9 mm
Compatible sanders	Dynabrade 56854B, 56819B, 56830B, 56863B, 56844B, 57404B, 57814B
Control valve	
Air supply inlet/outlet	1/4" NPT thread
Sanding media kit	
Grits	60, 80, 120, 320, 400

WHAT'S NEXT?

Get access to the Sanding Kit specifications at support.robotiq.com

For further information
support.robotiq.com
iss@robotiq.com
 1-888-Robotiq

